



DEPARTMENT OF THE ARMY
U.S. ARMY CORPS OF ENGINEERS, PHILADELPHIA DISTRICT
100 PENN SQUARE EAST
PHILADELPHIA PENNSYLVANIA 19107-3390

May 19, 2021

Regulatory Branch

SUBJECT: Nationwide Permit #14 Linear Transportation Projects Verification CENAP-OP-R-2021-00306-95

New Jersey Department of Transportation – Route 130 Bridge over Pennsauken Creek Scour Repair Project; Township of Cinnaminson, Burlington County, New Jersey; and Township of Pennsauken, Camden County, New Jersey

Latitude: 39.985282 Longitude: -75.014864

NJDEP Permit Number: 0000-20-0024.1; LUP200001

New Jersey Department of Transportation

Attn: Brendan Brock

1035 Parkway Avenue

Ewing, NJ 08618

Dear Mr. Brock:

This letter is written in regard to your proposal to undertake bridge scour repairs consisting of placement of filter fabric on the creek bottom, placement of course aggregate/rip-rap, and placement of a stone mattress atop the rip-rap and pier footings; resulting in the permanent discharge of approximately 789.0-cubic yards of rip-rap and 377.17-cubic yards of stone mattress into 0.213-acres of Waters of the U.S. This project is located in Pennsauken Creek at the Route 130 Bridge in the Township of Cinnaminson, Burlington County, New Jersey, and the Township of Pennsauken, Camden County, New Jersey. Based upon our review of the information you have provided, it has been determined that the proposed work is authorized by Department of the Army Nationwide Permit (NWP) #14 Linear Transportation Projects pursuant to Section 10 of the Rivers and Harbors Act of 1899 (33 USC 403) and Section 404 of the Clean Water Act (33 USC 1344).

This verification of authorization under NWP #14 Linear Transportation Projects, described in the Federal Register at 82 FR 1860, is based on your agreement to comply with the general conditions, regional conditions and project specific special conditions listed in this letter. Copies of the NWP descriptions, NWP general conditions and the NWP regional conditions for New Jersey can be found at:

2017 NWP Descriptions:

<https://www.nap.usace.army.mil/Portals/39/docs/regulatory/nwp/2017-NWP-Descriptions.pdf?ver=2020-05-12-205253-183>

2017 NWP General Conditions:

<https://www.nap.usace.army.mil/Portals/39/docs/regulatory/publicnotices/2017%20Nationwide%20Permit%20General%20Conditions.pdf>

2017 New Jersey Regional Conditions:

https://www.nap.usace.army.mil/Portals/39/docs/regulatory/publicnotices/2017_NJ_Reg_Cond_Final.pdf

Federal permits require determination from the State that the activities are consistent with the State's coastal zone management (CZM) program if the activity is located within the State's coastal zone. Federal permits also require the State's certification of compliance with section 401 of the Clean Water Act through the receipt of a 401 Water Quality Certification (WQC) if the activity involves a Section 404 discharge. An individual water quality certification is required and has not been issued or waived to date. A provisional general permit will be verified for this activity. An individual CZM consistency concurrence is required and has not been issued, waived or presumed to date. A provisional general permit will be verified for this activity. Therefore, no further action is needed as part of the Federal review of your project, provided that you comply with all the terms and conditions of this NWP.

This verification of NWP authorization is valid until the Nationwide Permits expire on **March 18, 2022**, unless the NWP authorization is modified, suspended, or revoked prior to this date. In the event that the NWP authorization is modified during that time period, this expiration date will remain valid, provided the activity complies with any subsequent modification of the NWP authorization.

Activities which have commenced (i.e. are under construction) or are under contract to commence in reliance upon an NWP will remain authorized provided the activity is completed within twelve months of the date of an NWP's expiration, modification, or revocation, unless discretionary authority has been exercised on a case-by-case basis to modify, suspend, or revoke the authorization in accordance with 33 CFR 330.4(e) and 33 CFR 330.5 (c) or (d). Activities completed under the authorization of an NWP which was in effect at the time the activity was completed continue to be authorized by that NWP.

Special Conditions:

1. All work performed in association with the subject project shall be conducted in accordance with the **enclosed** project plans identified as E-1 through E-6, all entitled NAP-2021-00306-95 and all date stamped 29 April 2021.
2. Construction activities shall not result in the disturbance or alteration of greater than 0.410 acres of waters of the United States.
3. Any deviation in construction methodology or project design from that shown on the enclosed project plans must be approved by this office, in writing, prior to

performance of the work. All modifications to the enclosed project plans shall be approved, in writing, by this office. No work shall be performed prior to written approval of this office.

4. The permittee understands and agrees that, if future operations by the United States require the removal, relocation, or other alteration, of the structure or work herein authorized, or if, in the opinion of the Secretary of the Army or his authorized representative, said structure or work shall cause unreasonable obstruction to the free navigation of the navigable waters, the permittee will be required, upon due notice from the Corps of Engineers, to remove, relocate, or alter the structural work or obstructions caused thereby, without expense to the United States. No claim shall be made against the United States on account of any such removal or alteration.
5. You must allow representatives from this office to inspect the authorized activity at any time deemed necessary to ensure that it is being or has been accomplished in accordance with the terms and conditions of your general permit.
6. Any conditions in your State authorization required for compliance with the State CZM program and 401 WQC are conditions of this authorization by reference.
7. In accordance with Regional General Condition G-6 of the 2017 Nationwide Regional Permit Conditions for the State of New Jersey, to protect diadromous fish migrations and spawning, in-water work shall be avoided from the mouth of the Delaware Bay to the U.S. Route 1 Bridge, and ALL tributaries within this reach, from March 1 to June 30.

Also **enclosed** with this NWP verification letter is a form seeking any comments, positive or otherwise, on the procedures, timeliness, fairness, etc. of the permit process. You may forward your comments along with the signed "Notification of Commencement" form or "Notification of Completion" form, following the directions provided on the form. If you should have any questions or concerns, please contact me at 215-656-6729 or robert.youhas@usace.army.mil.

Sincerely,

Robert Youhas
Biologist, Applications Section II

Enclosures

Copies furnished (via email):
Craig Hanlon, WSP

Enclosures:

- 1) Notification/Certification of Work Commencement Form
- 2) Notification/Certification of Work Completion/Compliance Form
- 3) Comment Form

PROJECT PLANS

STATE	FEDERAL PROJECT NO.	SHEET	TOTAL SHEETS
NJ			
STRUCTURE NO. 0422-86			
ROUTING AND OVER THE NORTH BRANCH OF THE PENNSAUKENN CREEK			

- NOTES:**
1. GROUTING AND IMPLEMENT PERMEATION GROUTING IN ACCORDANCE WITH SPECIFICATION - PERMEATION GROUTING.
 2. THE LOCATION OF THE PERMEATION GROUTING ZONE IS APPROXIMATE LAYOUT OF THE GROUT ZONE SHALL BE SUBJECT TO REVIEW AND APPROVAL OF THE DEPARTMENT.
 3. THE CONTRACTOR SHALL CONFIRM THE LOCATION OF ALL UTILITIES PRIOR TO BEGINNING THE WORK.
 4. PLAN AND SECTION SHOWN WERE DEVELOPED FROM AVAILABLE INDOT BRIDGE PLANS ENTITLED, "PENNSAUKENN CREEK BRIDGE WIDENING AND PENNSAUKENN CREEK BRIDGE WIDENING EAST ABUTMENT BRIDGE DATED DECEMBER 9, 1959 AND PENNSAUKENN CREEK BRIDGE WIDENING EAST ABUTMENT BRIDGE DATED 89 OF 895, DATED DECEMBER 9, 1959, RESPECTIVELY.
 5. ELEVATIONS SHOWN ARE NORTH AMERICAN VERTICAL DATUM (NGVD) 1988.
 6. THE LOCATION AND ELEVATION OF THE EXISTING 30 INCH DIAMETER CAST-IRON STORM DRAIN LINE IS APPROXIMATE. CONFIRM ITS LOCATION PRIOR TO THE START OF THE GROUTING OPERATION. INCLUDE PROVISIONS IN THE DESIGN OF THE GROUTING PROGRAM TO PROVIDE GROUTING UNDEROVER AND SUBSEQUENT TO GROUTING OPERATION.
 7. MONITOR DEFORMATION MONITORING POINTS DAILY DURING PERMEATION GROUTING OPERATION. SUBMIT DEFORMATION MONITORING RESULTS TO THE DEPARTMENT DAILY. MAXIMUM ALLOWABLE LATERAL DEFORMATION IS 0.25 INCHES.

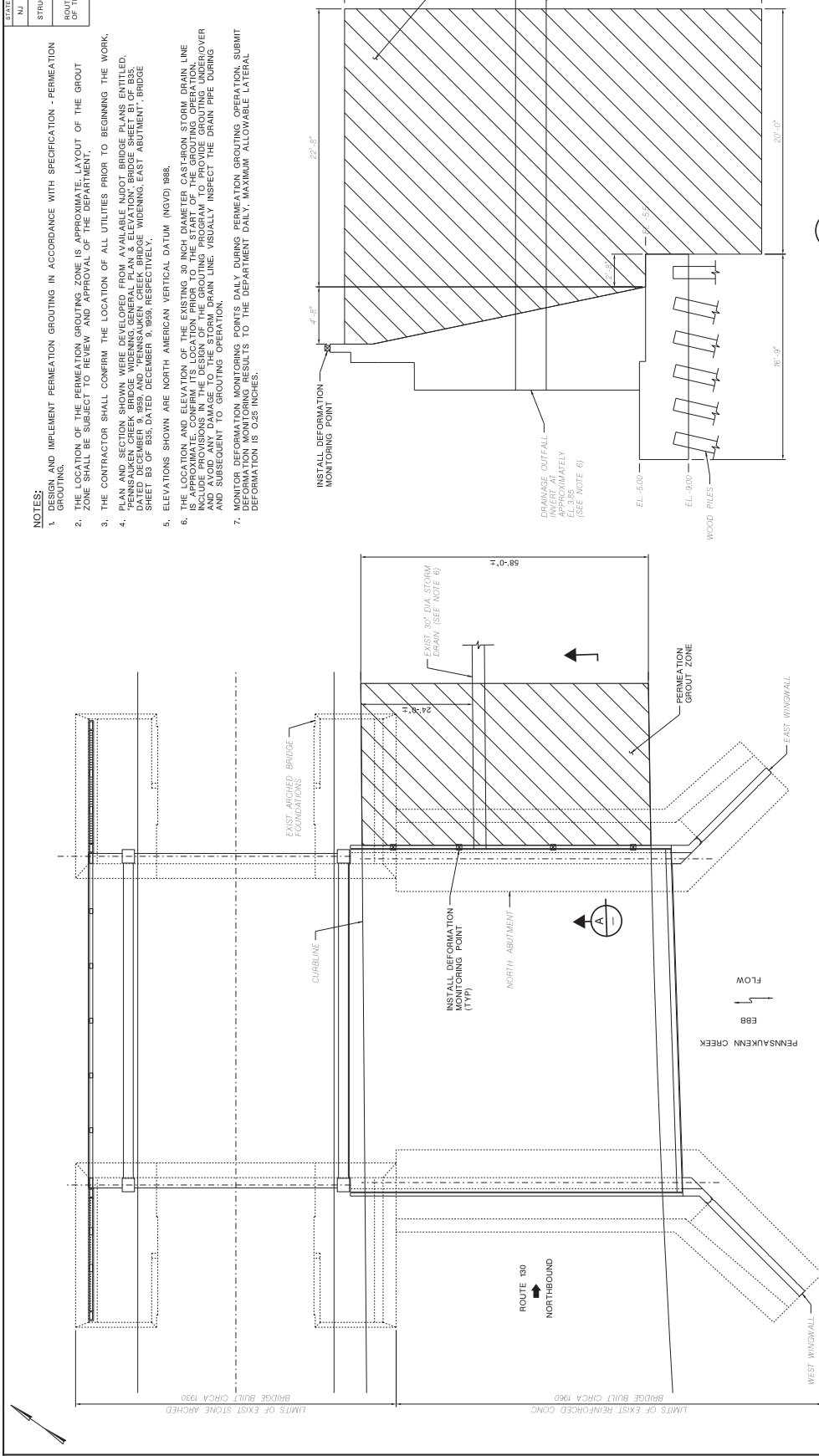

SECTION A
1/2" = 1'-0"

**NEW JERSEY DEPARTMENT OF TRANSPORTATION
BUREAU OF STRUCTURAL ENGINEERING**

**PERMEATION GROUTING PLAN
AND SECTION**

ROUTE US 130 OVER THE NORTH BRANCH
OF THE PENNSAUKENN CREEK BRIDGE
EMERGENCY SCOUR AND SINKHOLE REPAIR

WSP USA Inc. CERTIFICATION OF AUTHORIZATION NO. PGE02829900	SCALE: AS SHOWN
ELL D. LAMBERT III NEW JERSEY PROFESSIONAL ENGINEER LICENSE NO. 365285000	BRIDGE SHEET NO. 2 OF 6

REVISION	BY	CHK	DATE

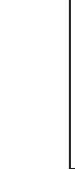

DESIGN SECTION	JOB NO.
DES BY R. FARMY	CHK D. ZALESKI
DES BY P. MANAYATH	BY R. RISHIRDIAN
EST BY D. ZALESKI	CHK D. LAMBERT
EST BY R. FARMY	BY R. FARMY
IN CHARGE OF: ELL D. LAMBERT III	

STATE	FEDERAL PROJECT NO.	SHEET	TOTAL SHEETS
NJ			
STRUCTURE NO. 0422-98			
ROUTE US 130 OVER THE NORTH BRANCH OF THE PENNSAUKEN CREEK			

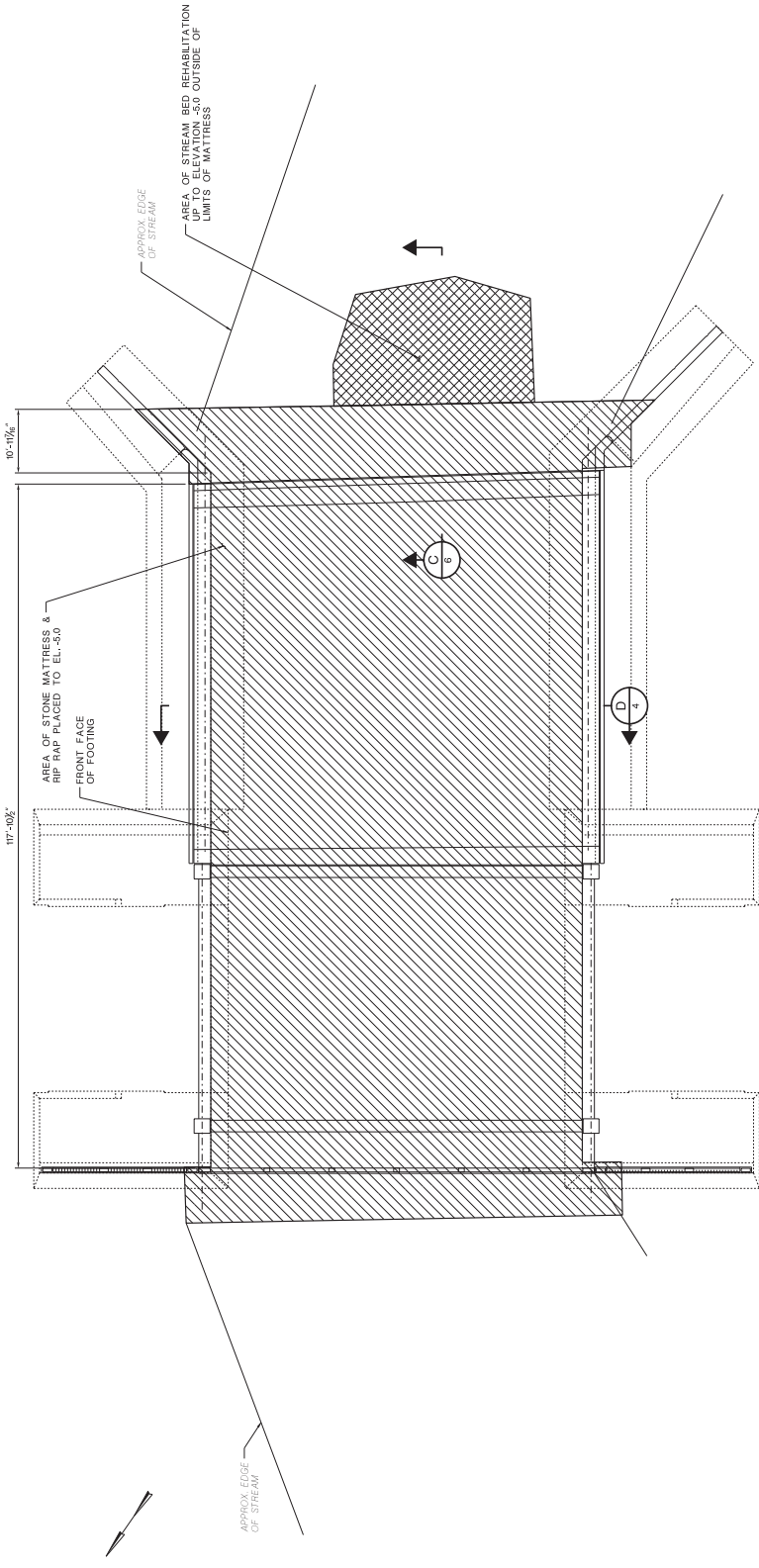

- LEGEND:**
- AREA OF STONE MATRESS & RIP RAP PLACED TO EL. -5.0
 - AREA OF STREAM BED REHABILITATION (RIP RAP) UP TO EL. -5.0

SCOUR COUNTERMEASURES

- NOTES:**
1. THE SCOUR COUNTERMEASURES HAVE BEEN DESIGNED IN ACCORDANCE WITH FHWA'S HYDRAULIC ENGINEERING CIRCULAR 107, CHAPTER 10, AND THE FIELD CONDITIONS MUST BE CONFIRMED PRIOR TO ORDERING MATERIALS OR STARTING THE WORK.
 2. REFER TO THE SPECIAL PROVISIONS FOR DETAILED REQUIREMENTS FOR SCOUR COUNTERMEASURES.
 3. THE STONE MATRESS AND RIP RAP IS A GENERAL GUIDE AND INDIVIDUAL MATRESS DIMENSIONS BASED ON THEIR MEANS SHALL BE STAGGERED.
 4. THE MINIMUM STONE MATRESS SIZE SHALL BE 60 SQUARE FEET UNLESS OTHERWISE APPROVED BY THE DEPARTMENT.
 5. GEOTEXTILE SHALL BE PLACED CONTINUOUSLY BENEATH THE STONE MATRESS WITH LAPPED JOINTS PLACED AS NEEDED. THE FABRIC IS STABLE PRIOR TO INSTALLATION OF THE STONE MATRESS. THE COST FOR ANY PINS AND EFFORT NEEDED TO STABILIZE THE GEOTEXTILE SHALL BE INCLUDED IN THE GEOTEXTILE PAY ITEM.
 6. PAY ITEM "SCOUR COUNTERMEASURES" ONLY APPLIES TO THE STONE MATRESS AND ASSOCIATED INCIDENTALS INCLUDING GROUND ANCHORS.
 7. THE CONTRACTOR IS TO CALCULATE THE REQUIRED HEADROOM AVAILABLE FOR CONSTRUCTION OF THE SCOUR COUNTERMEASURES. THE REPAIR PROCEDURES SELECTED SHALL ADEQUATELY ACCOMMODATE THE AVAILABLE WORK SPACE.

NEW JERSEY DEPARTMENT OF TRANSPORTATION
BUREAU OF STRUCTURAL ENGINEERING

SCOUR COUNTERMEASURES PLAN

ROUTE US 130 OVER THE NORTH BRANCH
OF THE PENNSAUKEN CREEK
EMERGENCY SCOUR AND SINKHOLE REPAIR

WSP USA Inc.	SCALE: AS SHOWN
CERTIFICATION OF AUTHORIZATION NO. R468282800	BRIDGE
E.L.D. LAMBERT III	SHEET NO. 3
NEW JERSEY PROFESSIONAL ENGINEER LICENSE NO. 245222800	OF 6



REVISION	BY	CHK	DATE

E-4 NAP-2021-00306-95 29 APRIL 2021

STATE	FEDERAL PROJECT NO.	SHEET	TOTAL SHEETS
NJ			
STRUCTURE NO. 0422-86			
ROUTE US 130 OVER THE NORTH BRANCH OF THE PENNSAUKEN CREEK			

NOTES:

- PRIOR TO PLACEMENT OF RIP RAP IN AREAS OUTSIDE THE RIP RAP INSTALLED UNDER EMERGENCY REPAIRS, PLACE GEOTEXTILE ON GROUND BED FOLLOWED BY 6 INCHES OF COARSE AGGREGATE.
- REQUIREMENTS FOR SCOUR COUNTERMEASURES INCLUDING STONE MATTRESS, GROUND ANCHORS, GEOTEXTILE, AND RIP RAP.

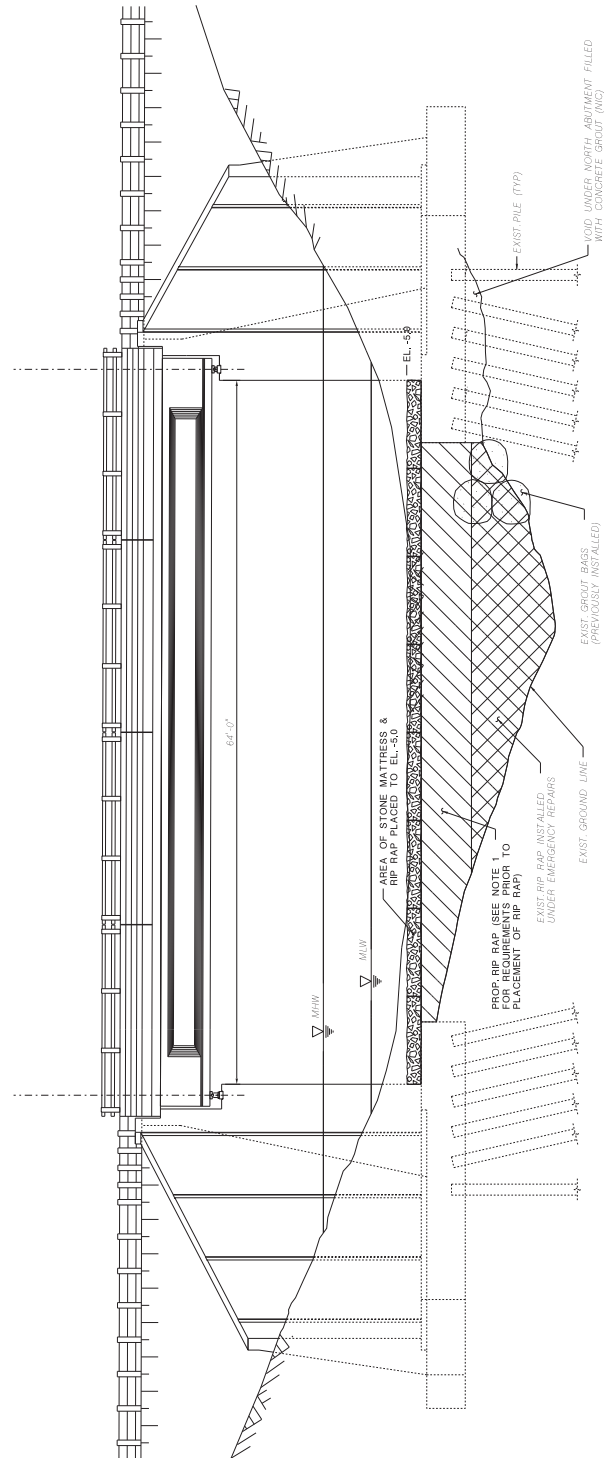

SECTION D
3/8" = 1'-0"

- LEGEND:
- PROPOSED STONE MATTRESS
 - PROPOSED RIP RAP
 - EXISTING RIP RAP INSTALLED UNDER EMERGENCY REPAIRS

NEW JERSEY DEPARTMENT OF TRANSPORTATION
BUREAU OF STRUCTURAL ENGINEERING

SCOUR COUNTERMEASURES ELEVATION

ROUTE US 130 OVER THE NORTH BRANCH OF THE PENNSAUKEN CREEK
EMERGENCY SCOUR AND SINKHOLE REPAIR

WSP USA Inc.
CERTIFICATION OF AUTHORIZATION NO. RJA62828000
E.L.D. LAMBERT III
NEW JERSEY PROFESSIONAL ENGINEER LICENSE NO. 365282800

SCALE: AS SHOWN

4 OF 6

CONTRACT NO.	SECTION	JOB NO.	
DES BY	R. FARHY	CHK BY	D. ZALESKI
EST BY	P. MANAYATH	CHK BY	R. RISHIKIRAN
DES BY	D. ZALESKI	CHK BY	D. LAMBERT
EST BY	R. FARHY	CHK BY	
IN CHARGE OF: E.L.D. LAMBERT III			

REVISION	BY	CHK	DATE

STATE	FEDERAL PROJECT NO.	SHEET	TOTAL SHEETS
NJ			
STRUCTURE NO. 0422-86			
ROUTE US 130 OVER THE NORTH BRANCH OF THE PENNSAUKEN CREEK			

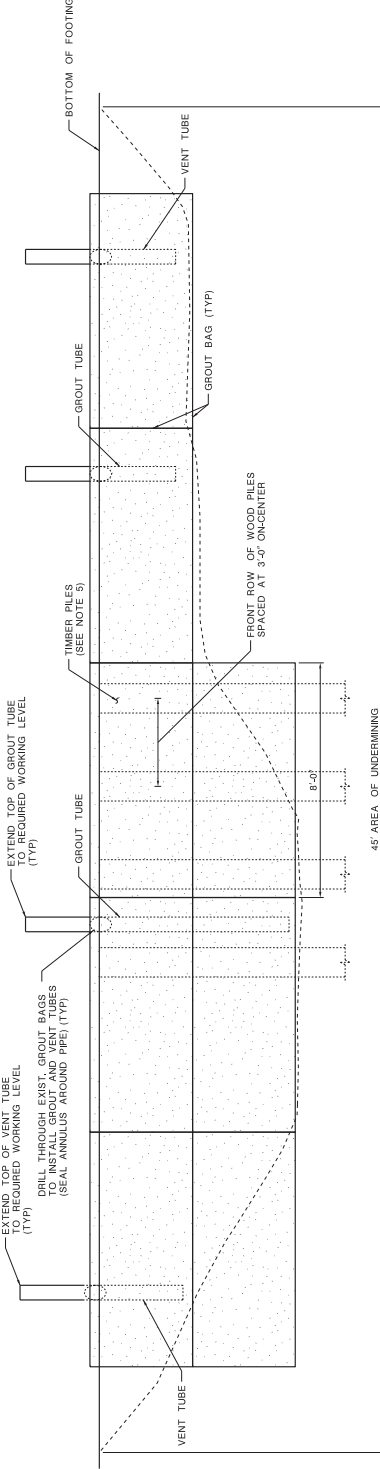

FOOTING ELEVATION
(LOOKING NORTH)
1/2" = 1'-0"

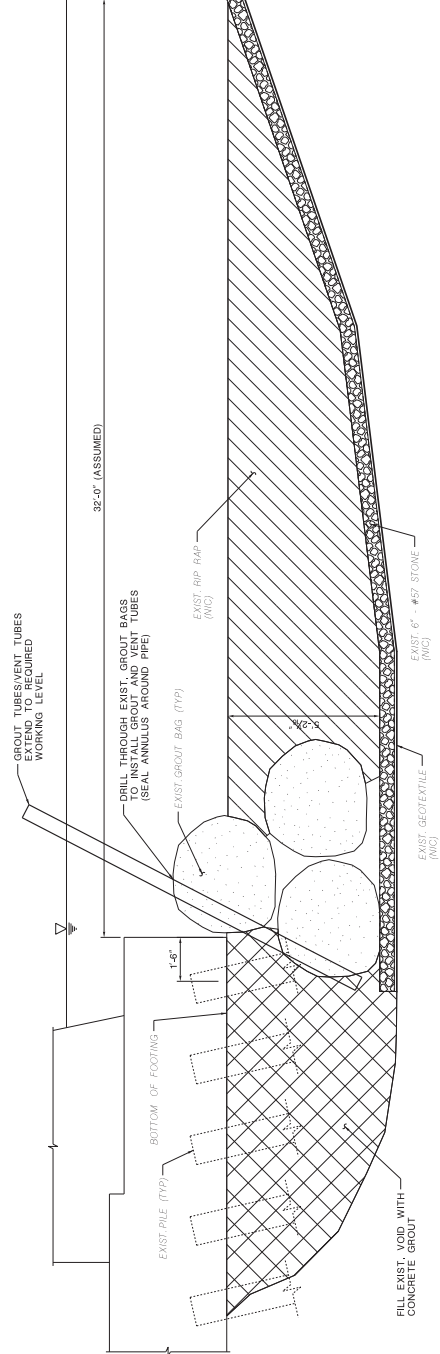

FOOTING SECTION
(LOOKING EAST/UPSTREAM)
1/2" = 1'-0"

- NOTES:**
1. GROUTING SHALL BE PERFORMED BY TREMIE GROUTING STARTING FROM LOWEST PORTION OF SCOUR HOLE IN BETWEEN EXISTING TIMBER PILES.
 2. IMPLEMENT VOID FILLING IN ACCORDANCE WITH THE SPECIAL PROVISIONS.
 3. THE LOCATION OF WORK PERFORMED UNDER THE PREVIOUS EMERGENCY REPAIR ORDER (GROUT BAGS, GEOTEXTILE STONE AND RIP RAP) ARE APPROPRIATE.
 4. THE LOCATION OF EXISTING VENT PIPES ARE TO BE IDENTIFIED AND REPAIRS TO BE MADE. CONTRACTOR SHALL PLACE AND INSTALL THESE PIPES IN ACCORDANCE WITH CONSTRUCTION MEANS AND METHODS.
 5. SPECIAL CARE SHALL BE REQUIRED WHEN INSTALLING GROUT BAGS AND VENT PIPES UNDER EXISTING WOOD PILES SUPPORTING THE BRIDGE. THE CONTRACTOR SHALL REVIEW THE AVAILABLE BRIDGE PILES TO DETERMINE THE LOCATION OF THE WOOD PILES.
 6. PRIORS TO VOID GROUTING, INSPECT FOR GAPS BETWEEN GROUT BAGS AND/OR BETWEEN GROUT BAGS AND THE PIPE CAP THAT WOULD RESULT IN VOIDING. CONTRACTOR SHALL BE RESPONSIBLE FOR IDENTIFYING ALL GAPS IN ACCORDANCE WITH THE APPROVED WORK PLAN.

NEW JERSEY DEPARTMENT OF TRANSPORTATION BUREAU OF STRUCTURAL ENGINEERING	
VOID FILL GROUTING DETAILS	
ROUTE US 130 OVER THE NORTH BRANCH OF THE PENNSAUKEN CREEK EMERGENCY SCOUR AND SINKHOLE REPAIR	
WSP USA Inc. CERTIFICATION OF AUTHORIZATION NO. JG482828000	SCALE: AS SHOWN
ELLI LAMBERT III NEW JERSEY PROFESSIONAL ENGINEER LICENSE NO. 365282000	BRIDGE
REVISION	BY
DATE	DATE

5	6
---	---

DESIGN SECTION	JOB NO.
DESIGNED BY: R. FARMY	CHKD BY: D. ZALESKI
ESTIMATED BY: P. MANAYATH	CHKD BY: R. RISHIRDIAN
ESTIMATED BY: R. FARMY	CHKD BY: D. LAMBERT
IN CHARGE OF: ELLI LAMBERT III	

ENCLOSURE 1

NOTIFICATION/CERTIFICATION OF WORK COMMENCEMENT FORM

Permit Number: CENAP-OPR-2021-00306-95
Name of Permittee: New Jersey Department of Transportation
Project Name: Route 130 Bridge over Pennsauken Creek Scour Repair Project
Waterway: Pennsauken Creek
County: Burlington and Camden Counties State: New Jersey
Compensation/Mitigation Work Required: Yes No

TO: U.S. Army Corps of Engineers, Philadelphia District
Wanamaker Building – 100 Penn Square East
Philadelphia, Pennsylvania 19107-3390
Attention: CENAP-OPR

I have received authorization to: undertake bridge scour repairs consisting of placement of filter fabric on the creek bottom, placement of course aggregate/rip-rap, and placement of a stone mattress atop the rip-rap and pier footings; resulting in the permanent discharge of approximately 789.0-cubic yards of rip-rap and 377.17-cubic yards of stone mattress into 0.213-acres of Waters of the U.S. This project is located in Pennsauken Creek at the Route 130 Bridge in the Township of Cinnaminson, Burlington County, New Jersey, and the Township of Pennsauken, Camden County, New Jersey.

The work will be performed by:

Name of Person or Firm: _____

Address: _____

I hereby certify that I have reviewed the approved plans, have read the terms and conditions of the above referenced permit, and shall perform the authorized work in strict accordance with the permit document. The authorized work will begin on or about _____ and should be completed on or about _____.

Please note that the permitted activity is subject to compliance inspections by the Army Corps of Engineers. If you fail to return this notification form or fail to comply with the terms or conditions of the permit, you are subject to permit suspension, modification, revocation, and/or penalties.

Permittee (Signature and Date)

Telephone Number

Contractor (Signature and Date)

Telephone Number

NOTE: This form shall be completed/signed and returned to the Philadelphia District Office prior to commencing work.

ENCLOSURE 2

NOTIFICATION/CERTIFICATION OF WORK COMPLETION/COMPLIANCE FORM

Permit Number: CENAP-OPR-2021-00306-95
Name of Permittee: New Jersey Department of Transportation
Name of Contractor: _____
Project Name: Route 130 Bridge over Pennsauken Creek Scour Repair Project
County: Burlington and Camden Counties State: New Jersey
Waterway: Pennsauken Creek

Within 10 days of completion of the activity authorized by this permit, please sign this certification and return it to the following address:

U.S. Army Corps of Engineers, Philadelphia District
Wanamaker Building - 100 Penn Square East
Philadelphia, Pennsylvania 19107-3390
Attention: CENAP-OPR

Please note that the permitted activity is subject to a compliance inspection by an Army Corps of Engineers representative. If you fail to return this notification form or fail to perform work in compliance with the permit, you are subject to administrative, civil and/or criminal penalties. Further, the subject permit may be suspended or revoked.

The authorized work was commenced on _____.

The authorized work was completed on _____.

I hereby certify that the work authorized by the above referenced permit has been completed in accordance with the terms and conditions of the above noted permit.

Signature of Contractor

Signature of Permittee

Address: _____

Address: _____

Telephone Number: _____

Telephone Number: _____

For project located in areas identified as shellfish habitat, you must include with this form a bill of lading; sales order or any other document(s) demonstrating non-polluting materials were purchased and utilized for your project. I hereby certify that I and/or my contractor have utilized non-polluting materials as defined in the above noted permit.

Signature of Contractor

Signature of Permittee

ENCLOSURE 3



**US Army Corps
of Engineers**
Philadelphia District

We are soliciting your views and comments concerning the processing of your Department of the Army permit application request. Any input, positive or otherwise, on procedures, timeliness, fairness, etc., would be appreciated.

Please write your comments in the space provided below and return to the Philadelphia District Regulatory Branch at PhiladelphiaDistrictRegulatory@usace.army.mil or if you do not have the means to return this form electronically you may print this document and mail to:

U.S. Army Corps of Engineers
Philadelphia District
Wanamaker Building
100 Penn Square East
Philadelphia, PA 19107-3390
Attn: Regulatory Branch

FILE NUMBER: _____
(Example CENAP-OP-R-2020-01234-56)

COMMENTS:

Thank you for taking the time to provide feedback which we can use to acknowledge great performance, correct problems and generally improve our business practices.